

IP66

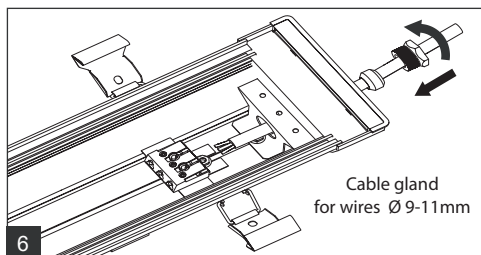

230V  
50/60Hz

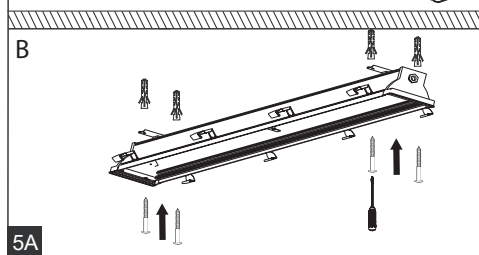
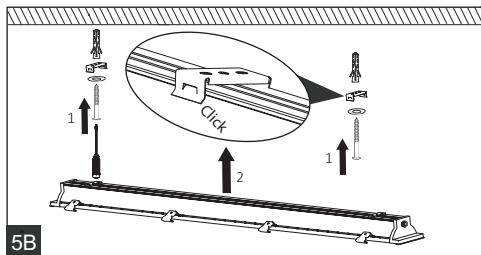
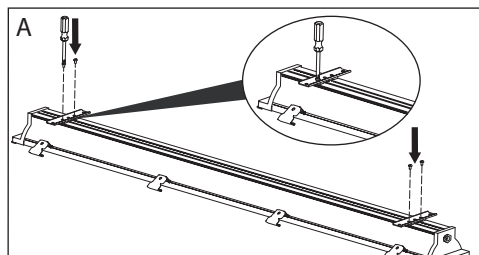
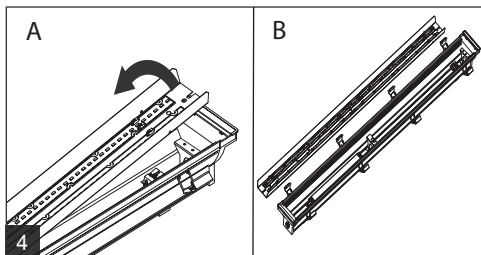
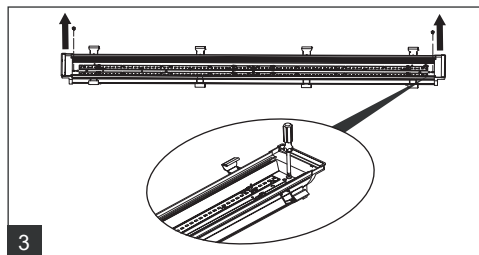
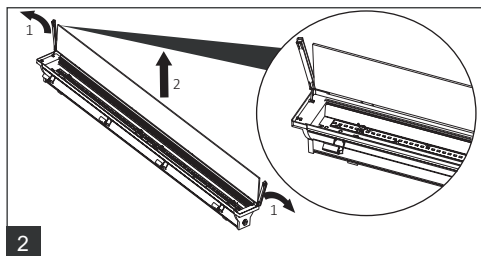
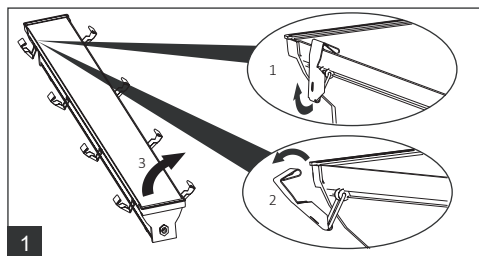
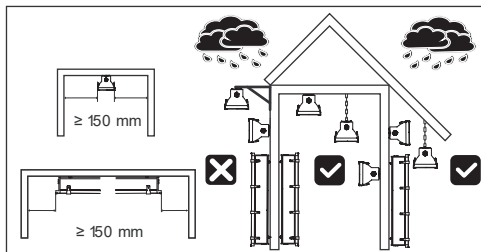
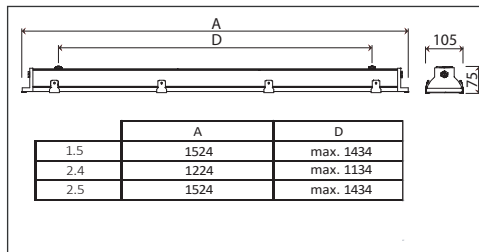
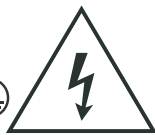

IP66

230V  
50/60Hz

Table of maximal number of luminaires in one line				10A B	16A B	10A C	16A C
Length	Σlm	Σlm	Σlm	luminaires	luminaires	luminaires	luminaires
1.5ft	4000	5500		20	32	33	54
2.4ft	6400	8800		11	18	18	30
2.5ft	8000	11000		11	18	18	30



**The light source in this luminaire may be replaced only by the manufacturer or its contractual service technician or similarly qualified person!**

Take care while fitting glass on rubber sealing for impacts on side of the glass and fast temperature changes. Properties of heat toughened glass and its susceptibility to breaking follow standard EN 12150-1.

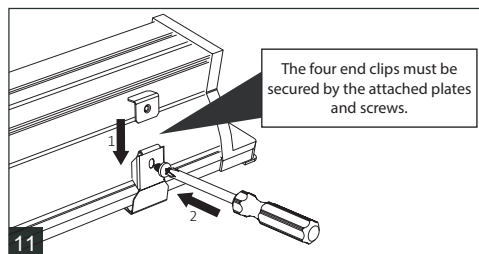
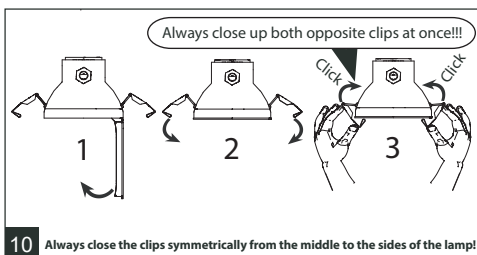
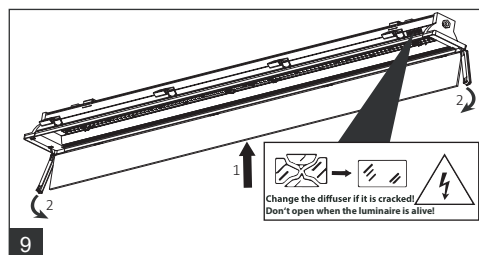
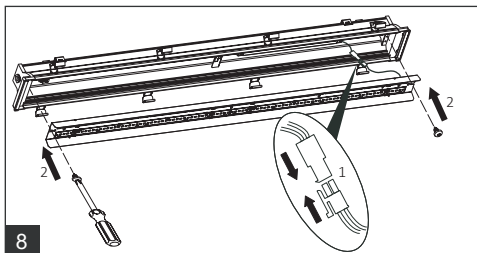
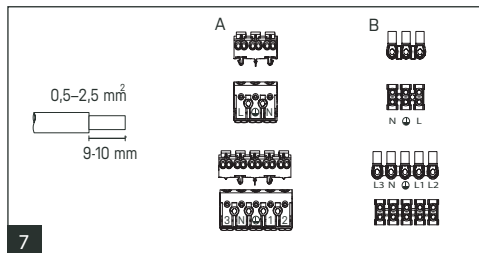
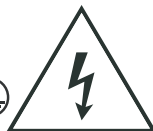
Installation can only be carried out by an authorized person and according to the mounting instructions. Any other installation is considered to be improper. For well installation and good luminaire work is necessary ensure a planarity of a mounting surface. Make sure that the luminaire is always disconnected from the power supply before the installation work. Do not use the luminaire if damaged or if damaged the power cable. Only damp microfiber cloth can be used for cleaning. Technical changes are subjected without notice. Do not dispose the luminaire or its parts as household waste, but make the proper recycling.