

IP65

220-240V
50/60Hz

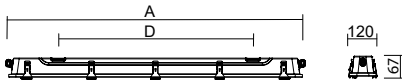

	A	D
1.2ft	680	360
1.4ft	1290	850
1.5ft	1600	1050

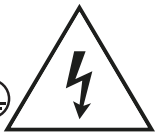
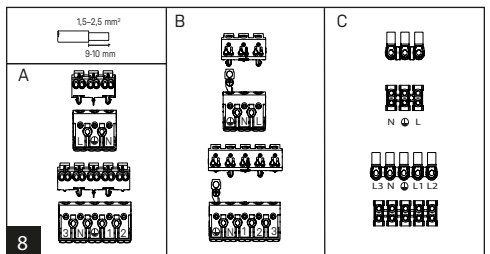
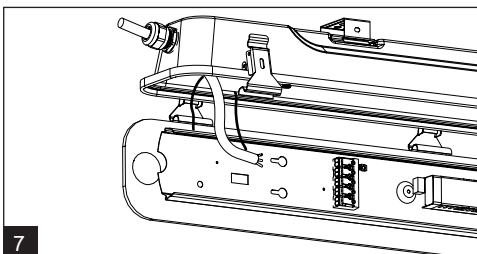
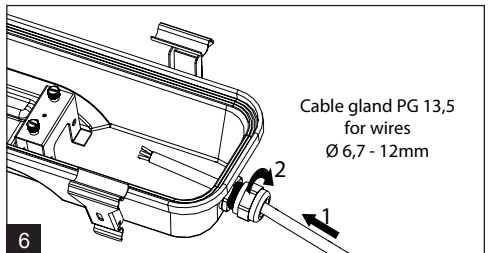
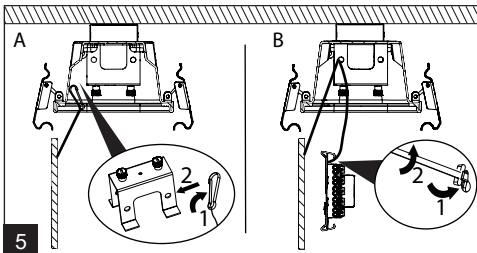
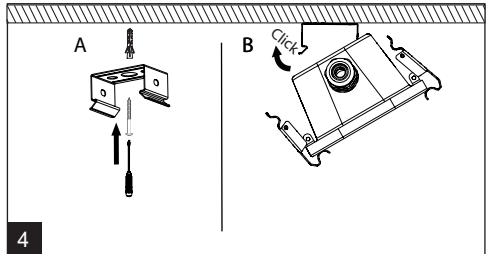
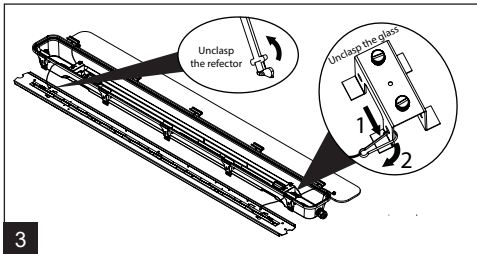
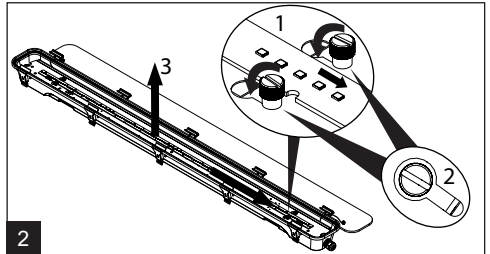
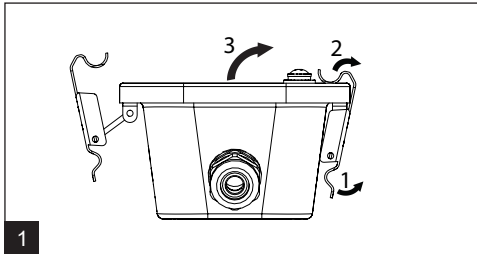
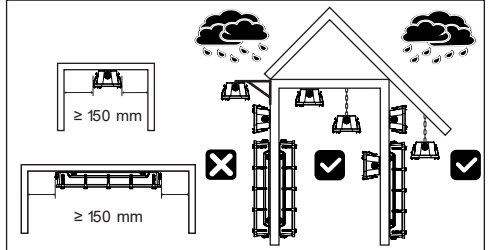

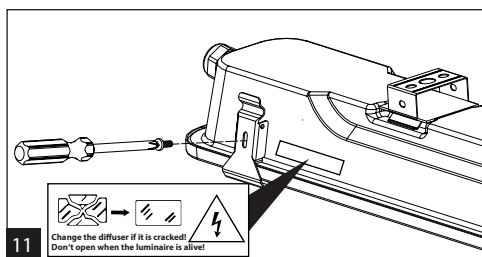
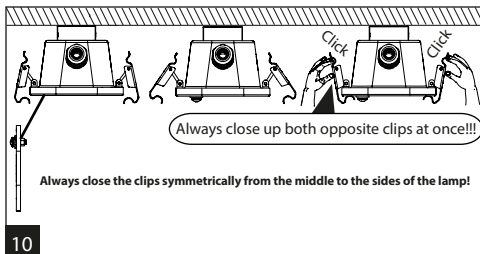
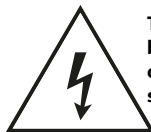

Table of maximal number of luminaires in one line				10A B Σ	16A B Σ	10A C Σ	16A C Σ
Length	Σ lm	Σ lm	Σ lm	luminaires	luminaires	luminaires	luminaires
1.2ft	1300	1600	2200	32	50	52	85
1.4ft	2600			32	50	52	85
1.4ft	3200	4400	6400	10	16	16	26
1.5ft	3250	4000	5500	10	16	16	26
1.5ft	8000			10	16	16	26



The light source in this luminaire may be replaced only by the manufacturer or its contractual service technician or similarly qualified person!

Installation can only be carried out by an authorized person and according to the mounting instructions. Any other installation is considered to be improper. For well installation and good luminaire work is necessary ensure a planarity of a mounting surface. Make sure that the luminaire is always disconnected from the power supply before the installation work. Do not use the luminaire if damaged or if damaged the power cable. Only damp microfiber cloth can be used for cleaning. Technical changes are subjected without notice. Do not dispose the luminaire or its parts as household waste, but make the proper recycling.

Take care while fitting glass on rubber sealing for impacts on side of the glass and fast temperature changes. Properties of heat toughened glass and its susceptibility to breaking follow standard EN 12150-1. For areas where spontaneous fracture of glass means a higher safety risk and/or financial loss, we recommend usage of safety film (SF). Individual cases should be discussed with our technicians.